

**GENERAL NOTES:**

A. SITE UTILITY SCOPE TO BE COORDINATED WITH VERMONT ELECTRIC COOPERATIVE.

B. BRANCH CIRCUIT HOMERUNS SHALL BE SIZED TO LIMIT VOLTAGE DROP TO 3% MAXIMUM. USE #8 IN 2" PVC CONDUIT MINIMUM.

C. REFER TO GROUNDING DIAGRAM 1E601 FOR GROUNDING REQUIREMENTS.

D. COORDINATE TELECOMMUNICATIONS AND TV SITE CONDUIT REQUIREMENTS WITH OWNER AND UTILITY. PROVIDE ALL REQUIRED SPLICES, PULLBOXES AND CABLE LENGTHS IN ACCORDANCE WITH UTILITY'S STANDARDS.

H. CONDUIT ROUTES AS SHOWN ARE DIAGRAMMATIC IN NATURE. FIELD VERIFY ACTUAL CONDUIT ROUTES PRIOR TO INSTALLING CONDUIT. PROVIDE PULLBOXES FOR SITE CABLING AS REQUIRED, BUT NOT TO EXCEED MORE THAN 200' BETWEEN BOXES.

**KEYNOTES:**

- CONDUITS FOR PHOTOVOLTAIC SYSTEM CONTINUE ON TO PHOTOVOLTAIC INVERTER. SEE SHEET C41Z FOR LOCATION OF INVERTER.
- APPROXIMATE LOCATION OF PROPOSED TEMPORARY UTILITY POLE.
- PROVIDE (1) 2" CONDUIT EXTENDED TO COMMUNICATIONS VAULT FOR FUTURE OWNER PROVIDED CASWELL STREET BRIDGE LED SIGNAGE AND CONTROL CABLING. COORDINATE WITH CIVIL FOR MORE INFORMATION.
- PROVIDE (1) 2" CONDUIT EXTENDED TO POWER VAULT FOR FUTURE OWNER PROVIDED CASWELL STREET BRIDGE LED SIGNAGE POWER WIRING. COORDINATE WITH CIVIL FOR MORE INFORMATION.
- PROVIDE TEMPORARY MAST ATTACHMENT TO EXISTING BUILDING FOR TEMPORARY UTILITY CONNECTION. PROVIDE 2" PVC FROM TEMPORARY MAST TO EXISTING BOILER ROOM.

**ARCHITECT**  
 HAMEL, GREEN AND ABRAHAMSON, INC.  
 420 NORTH 5TH STREET, SUITE 100  
 MINNEAPOLIS, MN 55401-2338  
 (612) 758-4000

**CIVIL ENGINEER**  
 HAMEL, GREEN AND ABRAHAMSON, INC.  
 420 NORTH 5TH STREET, SUITE 100  
 MINNEAPOLIS, MN 55401-2338  
 (612) 758-4000

**LANDSCAPE ARCHITECT**  
 HAMEL, GREEN AND ABRAHAMSON, INC.  
 420 NORTH 5TH STREET, SUITE 100  
 MINNEAPOLIS, MN 55401-2338  
 (612) 758-4000

**STRUCTURAL ENGINEER**  
 HAMEL, GREEN AND ABRAHAMSON, INC.  
 420 NORTH 5TH STREET, SUITE 100  
 MINNEAPOLIS, MN 55401-2338  
 (612) 758-4000

**MEP ENGINEER**  
 HAMEL, GREEN AND ABRAHAMSON, INC.  
 420 NORTH 5TH STREET, SUITE 100  
 MINNEAPOLIS, MN 55401-2338  
 (612) 758-4000

**GSA**  
 General Services Administration  
 Public Buildings Service  
 New England Region  
 Design and Construction Division  
 T P O'Neil FOB  
 10 Causeway St., 11th Floor  
 Boston, MA 02222-1077

**PROJECT INFORMATION**

**BUILDING NAME**  
 DERBY LINE I-91 LPOE

**ADDRESS**  
 INTERSTATE 91  
 DERBY LINE, VT

**MAIN PORT BUILDING NO.**  
 VT0861BD

**COMMERCIAL BUILDING NO.**  
 VT0863BD

**PROJECT TITLE**  
 DERBY LINE LPOE PORT REFRESH

**GSA PROJECT NO.**  
 NV100253

**CONTRACT INFORMATION**

**AE CONTRACT NO.**  
 GS-07P-09-H4-D-0028

**TASK ORDER NO.**  
 GS-P-01-14-BZ-5002

SENSITIVE BUT UNCLASSIFIED (SBU)  
 PROPERTY OF THE  
 UNITED STATES GOVERNMENT  
 FOR OFFICIAL USE ONLY  
 Do not remove this notice.  
 Properly destroy or return documents  
 when no longer needed.

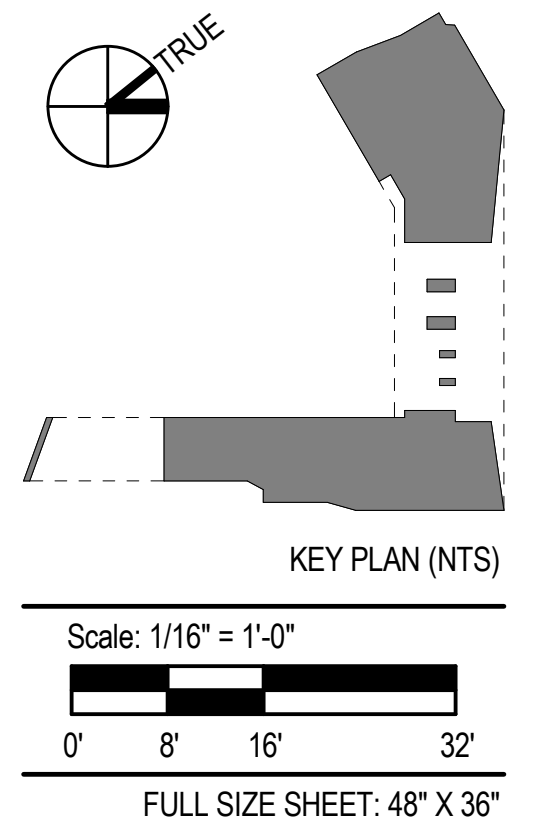

NO.	DESCRIPTION	DATE
1	Addendum No. 1	08/01/2016
2	Addendum No. 2	10/04/2016
4	CCD-1R	12/22/2016

ISSUANCE HISTORY - THIS SHEET

HGA NO: 2111-047-00

**ELECTRICAL  
 SITE DUCTBANK  
 AND PATHWAYS  
 PLAN**

DATE: SEPTEMBER 14, 2016

**CP-01**

**E030**

CONSTRUCTION DOCUMENTS

**1 SITE ELECTRICAL DUCT BANK**  
 1/16" = 1'-0"